



Tideway

**Chambers Wharf
Community Liaison Working Group
Monday 8 October 2018**



Tideway



GRANDS PROJETS



CONTENTS

- **Chambers Wharf Update**
- **Progress report**
- **Upcoming works**
- **Noise and Vibration**
- **Community Relations**

Acoustic Enclosure

- Installation 40% complete
- Installing steel frame until end of October
- Cladding started on the east and west elevations



Acoustic Enclosure – 69m long x 33m wide x 23m high

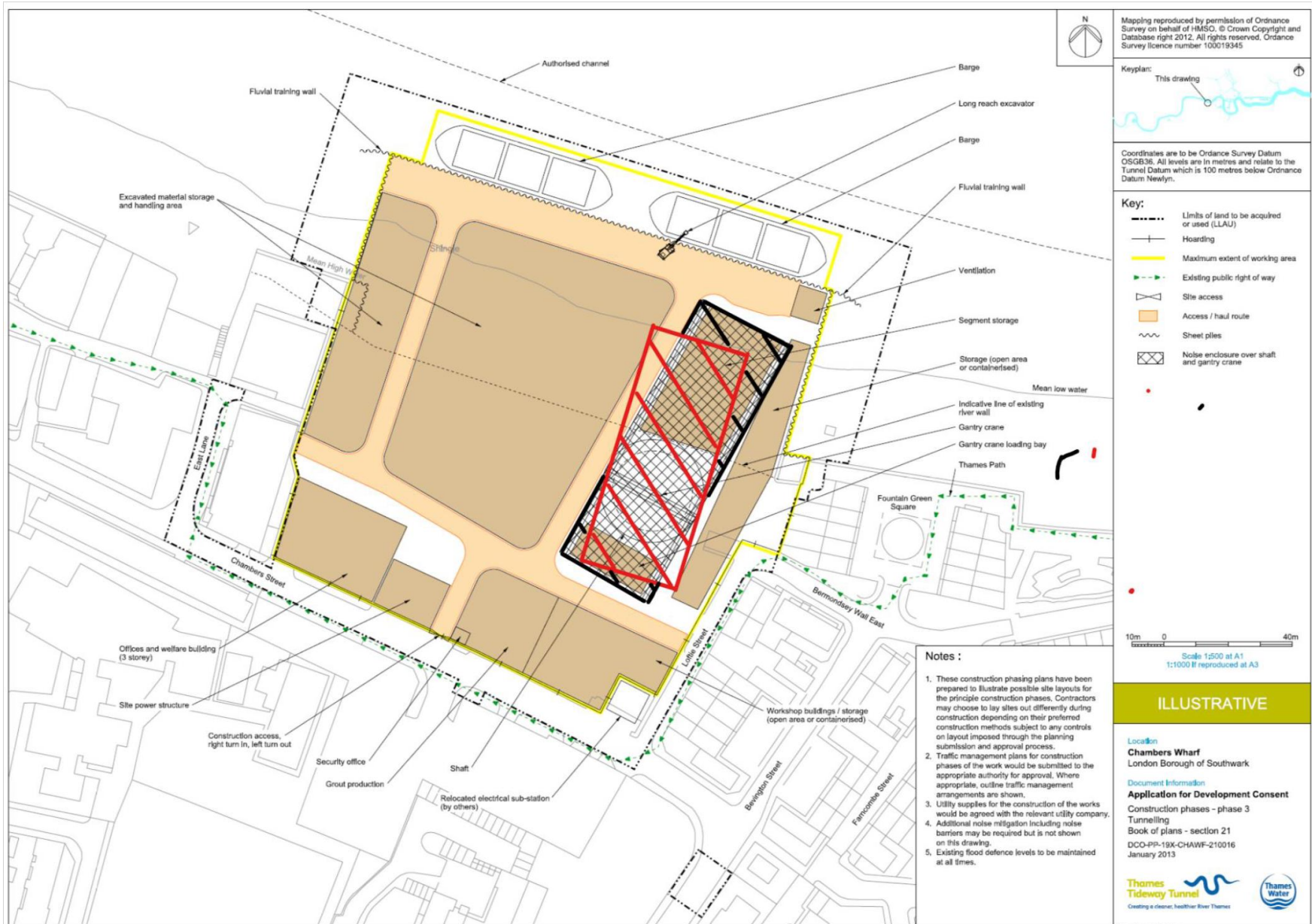

Slurry Treatment Plant Foundations

- Open tanks demolished and removed from site
- Further concrete breaking required to remove existing slabs
 - Saw cutting to reduce necessity for breaking
 - Two further days of breaking expected this week
- Formwork and reinforcement steel installation foundations
- Water treatment plant delivery in early November



Shaft Excavation – Summary

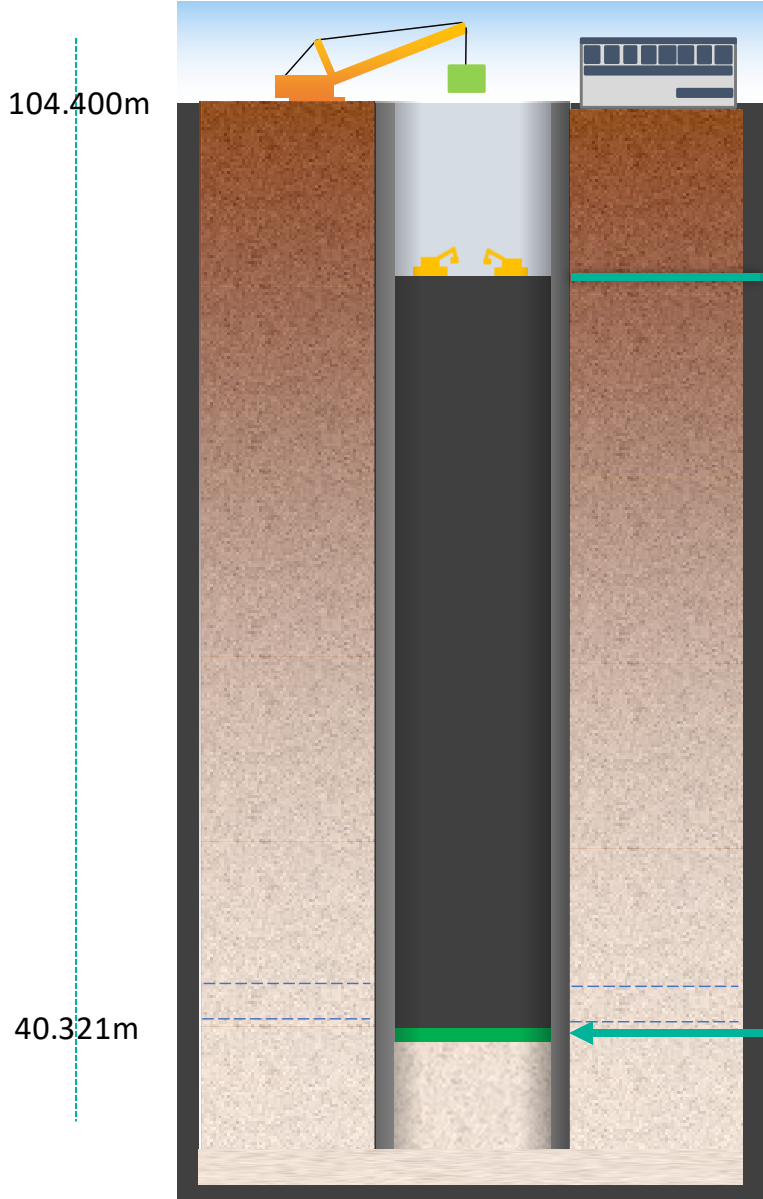

Depth (m):
12 m

Depth (mATD):
92.0 mATD



Bottom of base slab
Max. excavation depth
40.321m ATD

% Excavated
18.73%

Remedial works: panel 15 of shaft diaphragm walls

Working hours: up to 22:00 Mon-Fri; up to 13:00 Saturdays

Grouting outside of the wall panel – **Complete**

Digging a new wall panel outside of panel 15 – **Complete**

Removing affected part of the existing wall panel – **Complete**

Installing metal cages to reinforce the new panel – **Complete**

Concreting new wall panel, including the affected area within the existing wall panel – **Complete**

Jet grouting to ensure water tightness of shaft – **End of October**

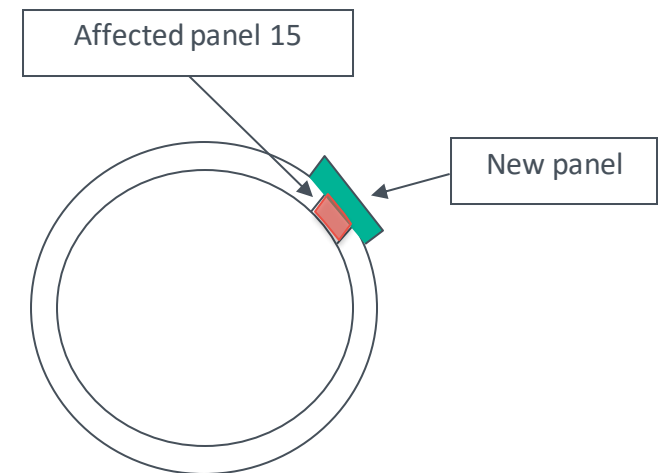

Barge movements – last 3 months

September:

7 barges
6,092 tonnes +
193 tonnes

Avoiding
approx. 315 lorry
movements



Section 61 for Shaft Construction Phase

Section 61 phase four covers anticipated construction work: June 2018 - Feb. 2019.

Minor amendments to S61 to cover programme changes and STP setup
– no changes to consented working hours

Permitted Site Working Hours

Standard Working Hours: 08:00 to 18:00 (Monday to Friday) and 08:00 to 13:00 (Saturday)

Extended Working Hours

- 18:00 to 22:00 (Monday to Friday). 08:00 to 17:00 (Saturday)
- General works limited to tidally influenced marine movements, lighting (task specific) and gantry crane movements within shaft enclosure
- Remedial works to panel 15 of the diaphragm wall (not after 13:00 on Saturdays)
- Base slab concrete pours
- Phase 2 shaft excavation material movements

Movement of excavated material outside of the shaft enclosure up to 20:00 Monday to Friday; up to 17:00 on Saturdays. For six weeks or to 30m depth, whichever is sooner.

Continuous Working Hours (24/7) For steel fixing and base slab preparatory works, phase 2 shaft excavation (within enclosure) and secondary concrete lining construction. Plus a pump test on completion using submerged electric pumps.

Mobilisation and demobilisation Hours

- 07:00 to 08:00 and 18:00 to 19:00 (Monday to Friday). 07:00 to 08:00 and 13:00 to 14:00 (Saturday)
- 22:00 to 22:30 (Extended working hours activities) (Monday to Friday). 17:00 to 17:30 (Extended working hours activities) (Saturday)

12-month draft look-ahead

Programme Overview	2018			2019								
	Oct	Nov	Dec	Jan	Feb	Mar	Apr	May	Jun	Jul	Aug	Sep
Diaphragm Wall Remedial	Standard Working Hours											
Archaeology/Excavation - Outside Enclosure	Standard Working Hours											
Erection of Acoustic Enclosure	Standard Working Hours											
Gantry Crane Installation	Standard Working Hours											
Main Shaft Excavation (24hr) Inside Enclosure				Continuous Working Hours	Continuous Working Hours	Continuous Working Hours						
Shaft Base Slab							Continuous Working Hours					
Shaft Secondary Lining and Portals								Continuous Working Hours	Continuous Working Hours	Continuous Working Hours		
Tunnelling Set Up												Continuous Working Hours
Slurry Treatment Plant - Foundations and Walls	Standard Working Hours											
Erection of Slurry Treatment Plant	Standard Working Hours											
Logistical movements into and out of Acoustic Enclosure - to 20.00hrs	Extended Working Hours											
Support Activities (Marine, Maintenance, etc.)	Extended Working Hours											
	Standard Working Hours	(08:00 - 18:00) Monday to Friday, (08:00 - 13:00) Saturday										
	Extended Working Hours	(08:00 - 22:00) Monday to Friday - Dwall and Support activities (08:00 - 13:00) Saturday - (Support activities to 17.00)										
	Continuous Working Hours	(00:00 - 00:00) Monday to Sunday										

CLWG Programme Summary

CLWG Month	Tunnelling Start	Tunnelling Complete	End of Construction	Commissioning Complete
March 2017	December 2018	October 2020	March 2022	December 2022
March 2018	June 2019	January 2021	March 2022	December 2022
April 2018	July 2019	March 2021	July 2022	June 2023
May 2018	July 2019	March 2021	July 2022	June 2023
June 2018	July 2019	March 2021	July 2022	June 2023
July 2018	July 2019	March 2021	July 2022	June 2023
August 2018	No CLWG			
September 2018	September 2019	March 2021	July 2022	June 2023
October 2018	September 2019	March 2021	July 2022	June 2023

Overview of Completed Acoustic Enclosure and STP

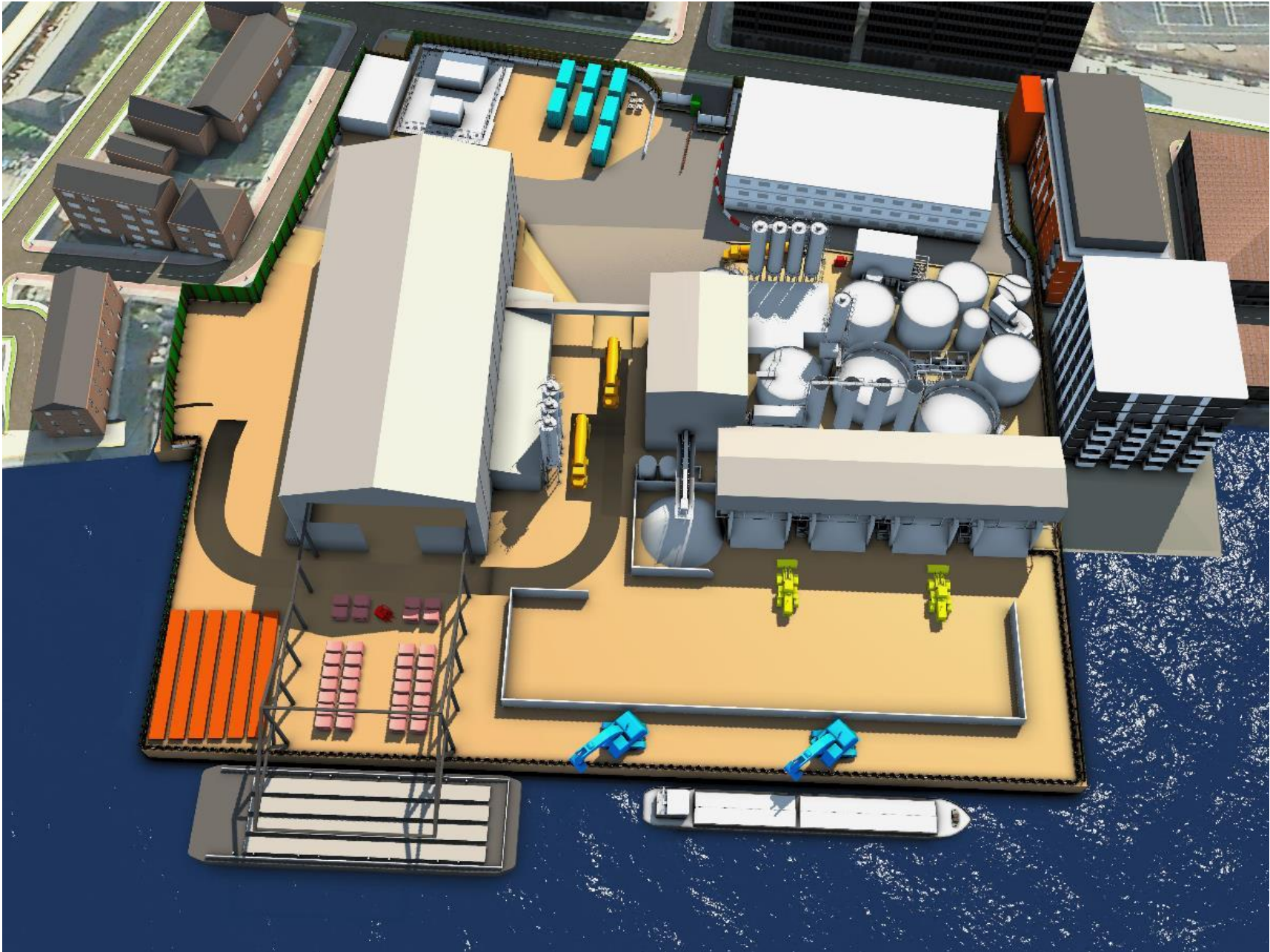

Noise and Air Quality Readings

Air – August 2018

Air Alerts (24hour limit)

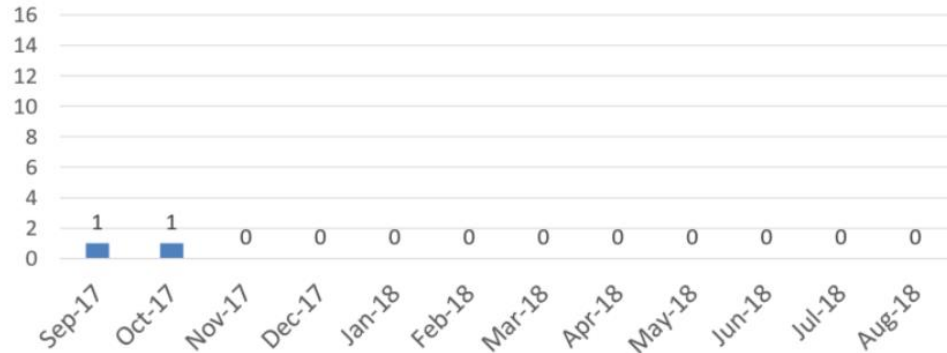

Location	UK Air Quality Objective	NO ₂ µg/m ³
DT1	40	21.49
DT2		22.68
DT3		25.00
DT4		18.63
DT5		26.10
DT6		26.92

There were no 24 hour dust alerts during August 2018.

Total Allowable Alerts	35 per year
Total August Alerts	0
Number of Alerts (12-month rolling)	2

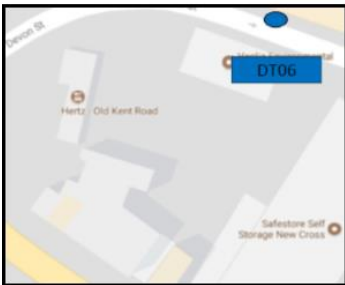
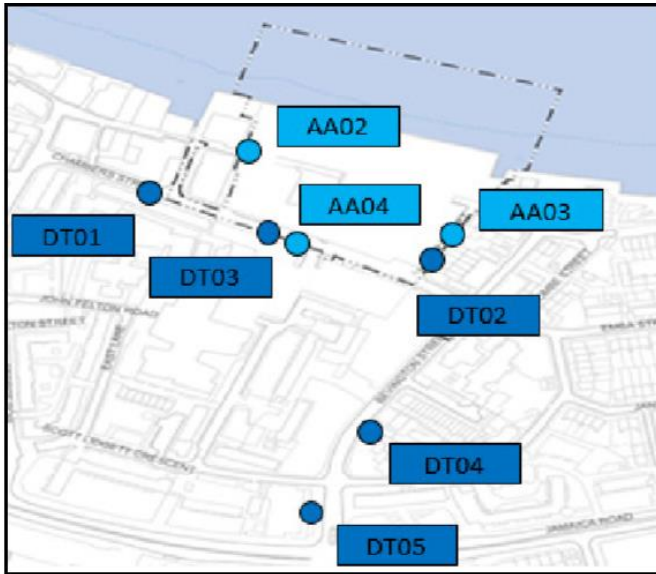

	TSP	PM10	PM2.5
Number of 24-hour mean PM10 alerts	-	0	-
Number of 15-min PM10 alerts	-	0	-
Monthly mean	18.63	11.04	5.40
Annual mean Air Quality Objective	-	40	25
Data Capture (%)	99	99	99

Noise – September 2018

Noise Monitor: NM05
Monthly Level (dB): 58
Days above PW17 threshold
(standard working hours);
i) 0 ii) 0, iii) 1

Noise Monitor: NM14
Monthly Level (dB): 63
Days above PW17 threshold
(standard working hours);
i) 0, ii) 0, iii) 0

Noise Monitor: NM13
Monthly Level (dB): 57
Days above PW17 threshold
(standard working hours);
i) 0, ii) 0, iii) 0

Noise Monitor: NM02
Monthly Level (dB): 64
Days above PW17 threshold
(standard working hours);
i) 0, ii) 0, iii) 0

Noise Monitor: NM12
Monthly Level (dB): 62
Days above PW17 threshold
(standard working hours);
i) 0, ii) 0, iii) 0

Noise Monitor: NM03
Monthly Level (dB): 62
Days above PW17 threshold
(standard working hours);
i) 0 ii) 0 iii) 1

Noise Monitor: NM06
Monthly Level (dB): 60
Days above PW17 threshold
(standard working hours);
i) 0, ii) 0, iii) 0

Noise Monitor: NM11
Monthly Level (dB): 57
Days above PW17 threshold
(standard working hours);
i) 0, ii) 0, iii) 0

Noise Monitor: NM04
Monthly Level (dB): 62
Days above PW17 threshold
(standard working hours);
i) 0, ii) 0, iii) 0

Noise Monitor: NM10
Monthly Level (dB): 59
Days above PW17 threshold
(standard working hours);
i) 0, ii) 0, iii) 1

Noise Monitor: NM07
Monthly Level (dB): 56
Days above PW17 threshold
(standard working hours);
i) 0, ii) 0, iii) 0

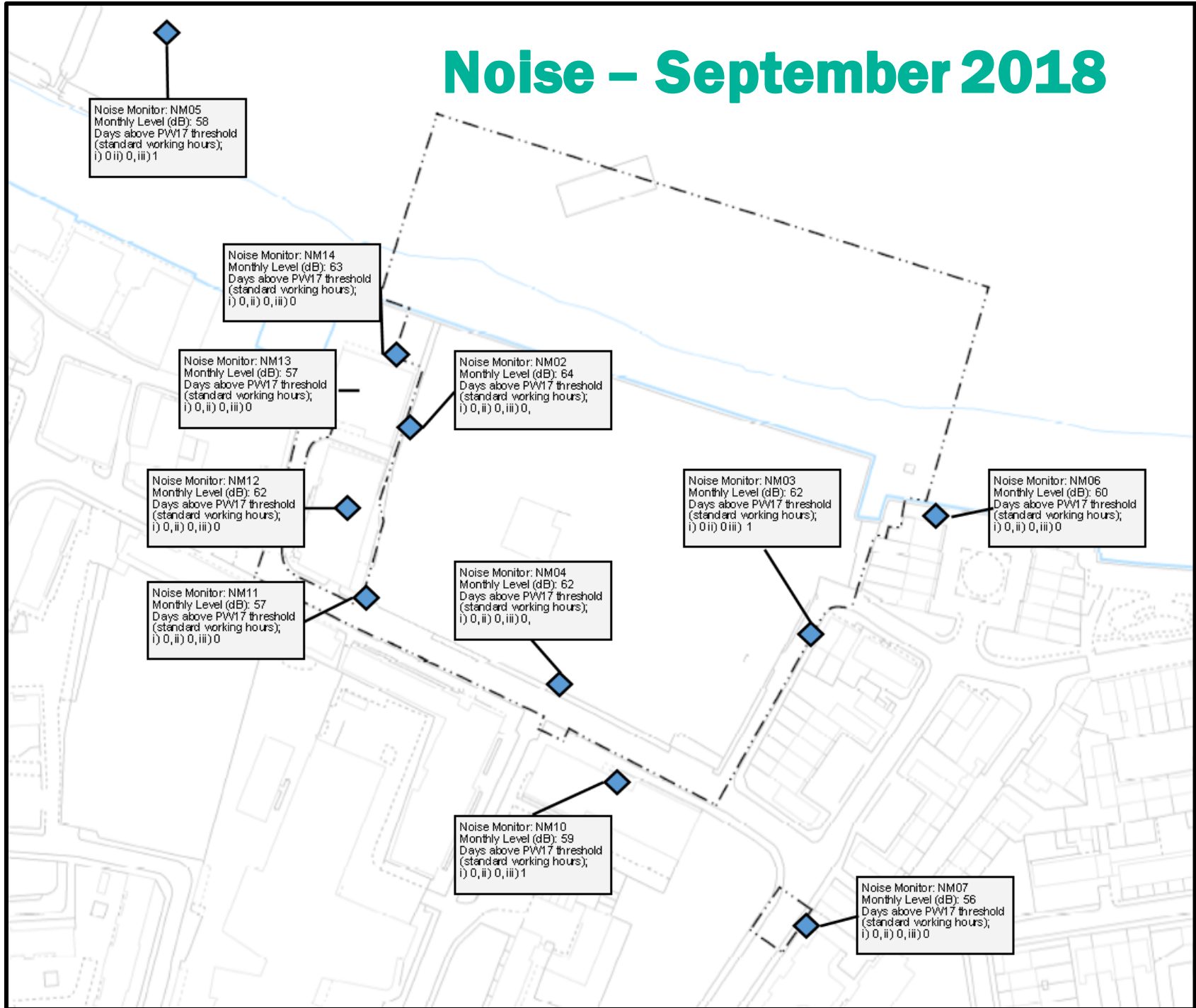

Air – September 2018

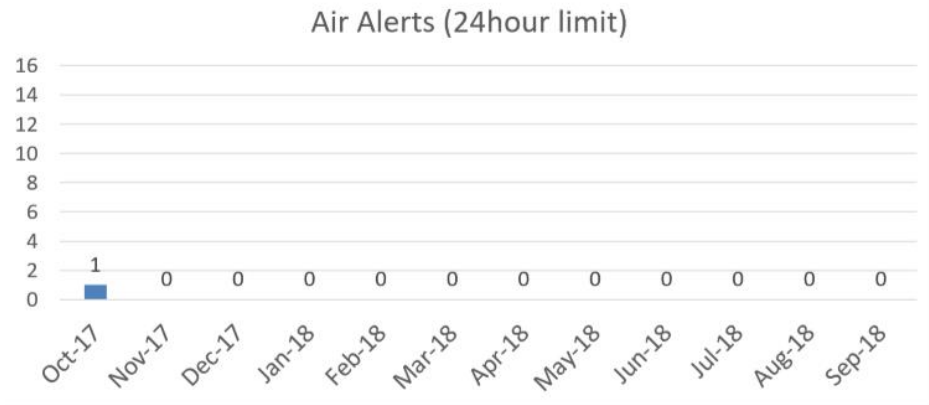
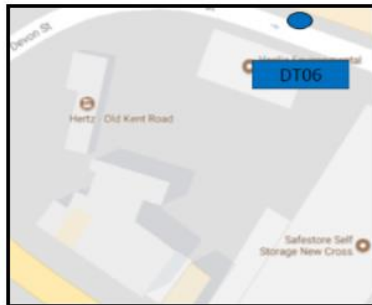
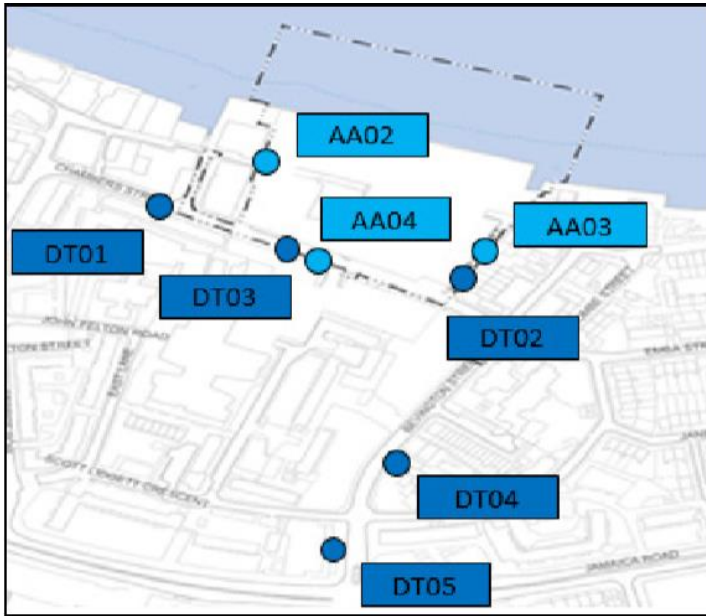

There were no 24 hour dust alerts during September 2018.

Total Allowable Alerts	35 per year
Total September Alerts	0
Number of Alerts (12-month rolling)	1

Community Relations across Tideway East

Big Ben Challenge – 20km Paddle Board



As part of the Tideway Foreshore Festival in September, a team of staff paddle boarders from Earl Pumping Station paddled from Putney Bridge in aid of 4 south London charities.

Charity fund raising

- Five Tideway East staff completed the British 10K run in July, in support of the Deborah Ubee Trust, a mental health charity based in Greenwich, raising over £800
- In September, staff raised over £600 with a Macmillan Coffee Morning
- A staff member is also running a half marathon to raise money for Macmillan on 14 October.



If you have any questions or enquiries please contact the Tideway Helpdesk on:

Telephone: 08000 308080

Email: Helpdesk@Tideway.London