



**Tideway**

**Deptford Church Street & Greenwich Pumping Station  
Community Liaison Working Group  
Tuesday 2 October 2018**

# Staff

## Tideway

- **Andy Sefton** senior project manager Greenwich
- **Gareth Howells** project manager Greenwich
- **Alastair Walker** project manager Deptford
- **Rebecca Major** Communications Officer
- **Michael Appleton** communications & Engagement Manager

## CVB

- **Sophie Lambert** Deptford Site Manager
- **Barbara Lantz** Greenwich Manager
- **June Saunders** Community Relations Officer
- **Heather Nickson** Environmental Adviser
- **Sophie Hart** Environmental Adviser

# CONTENTS

- **Deptford Update**
- **Progress report**
- **Upcoming works**
- **Traffic contraflow**
- **Noise and Vibration**
  
- **Greenwich Update**
- **Progress report**
- **Upcoming works**
- **Noise and Vibration**
  
- **Community Relations**

# Tideway Film

Please paste link into your browser to see film

[https://www.youtube.com/watch?v=cp\\_4Ao3GmdQ](https://www.youtube.com/watch?v=cp_4Ao3GmdQ)

Or

<https://vimeo.com/292937705>



# Deptford Church Street





# Birds' eye view

July 2018

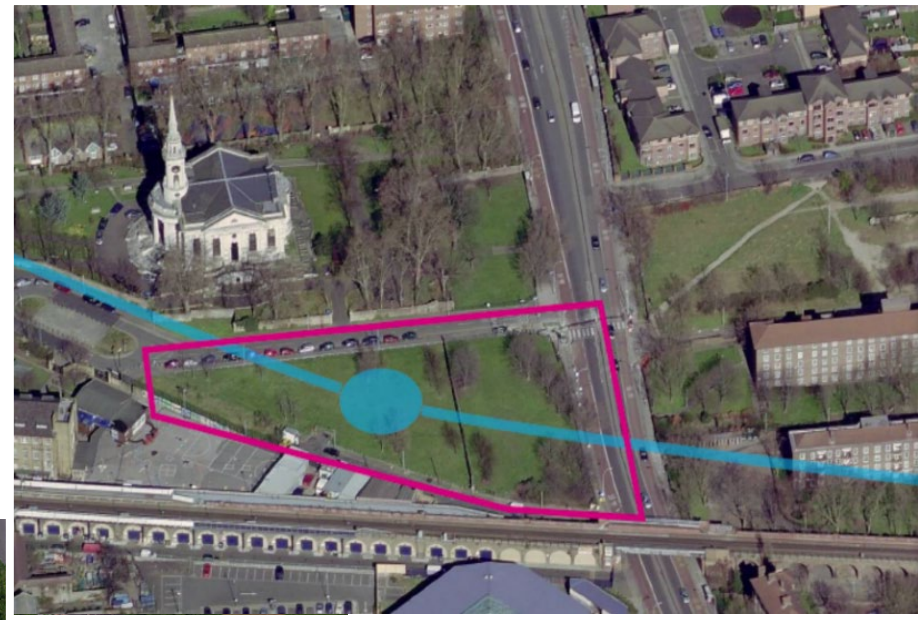



# General overview



# Deptford - Works Update

- **Finished the diaphragm walls of the shaft**
- **Continue to install the diaphragm walls of the interception chamber - 2 remain**
- **Preparing to insert two boreholes within the shaft, which will be around 70 metres deep and allow us to investigate groundwater**
- **Hoarding artwork installed on Crossfield and Coffey Streets**



# Deptford - The next 6 months



Programme Overview	2018			2019		
	October	November	December	January	February	March
Diaphragm wall demobilisation						
Shaft Groundwater investigation						
Shaft capping beam						
Shaft Curtain grouting						
Shaft excavation						
Interception chamber capping beam and roof beams						
Interception chamber Excavation						
Deptford Church street contra flow						

Working Hours	Standard	Extended
Monday – Friday	08:00 – 18:00	Until 22:00
Saturday	08:00 – 13:00	Until 17:00

*1 hour allowed before & after for mobilisation*

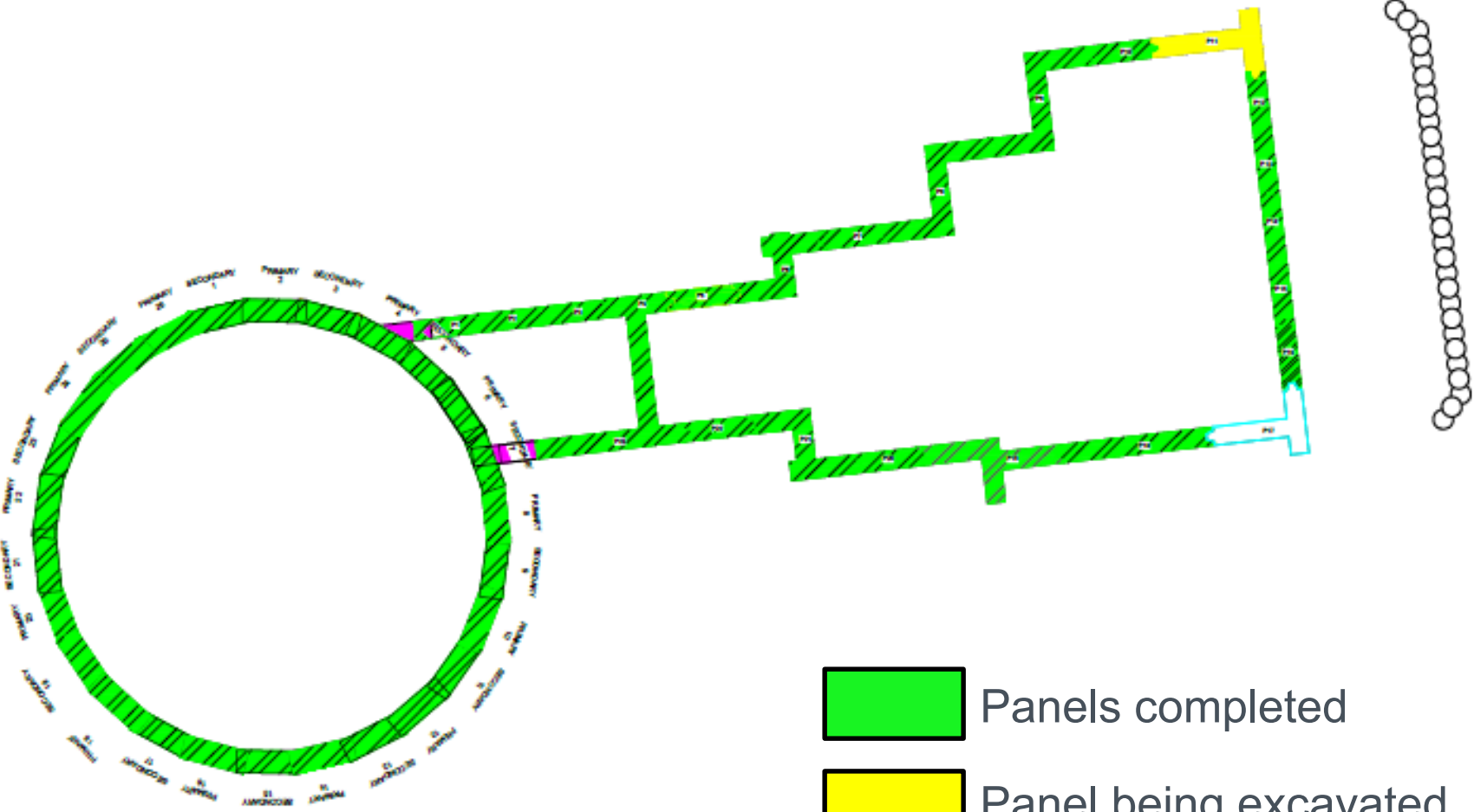
# Remaining interception chamber panels



-  Panels completed
-  Panel being excavated
-  Last panel to be excavated

# Deptford Church Street contraflow

- Extension of site onto the northbound lanes from November 2018 until late 2021
- Northbound lanes will be diverted into one of the southbound lanes
- The southbound lanes therefore have two-way traffic
- Resolution Way one-way traffic route reversed
- Vehicle access from Deptford Church Street
- Exit onto Deptford High Street
- Working hours
  - Mostly day time
  - A couple of evenings, (20:00 – 23.59 hrs), to avoid peak traffic interruption

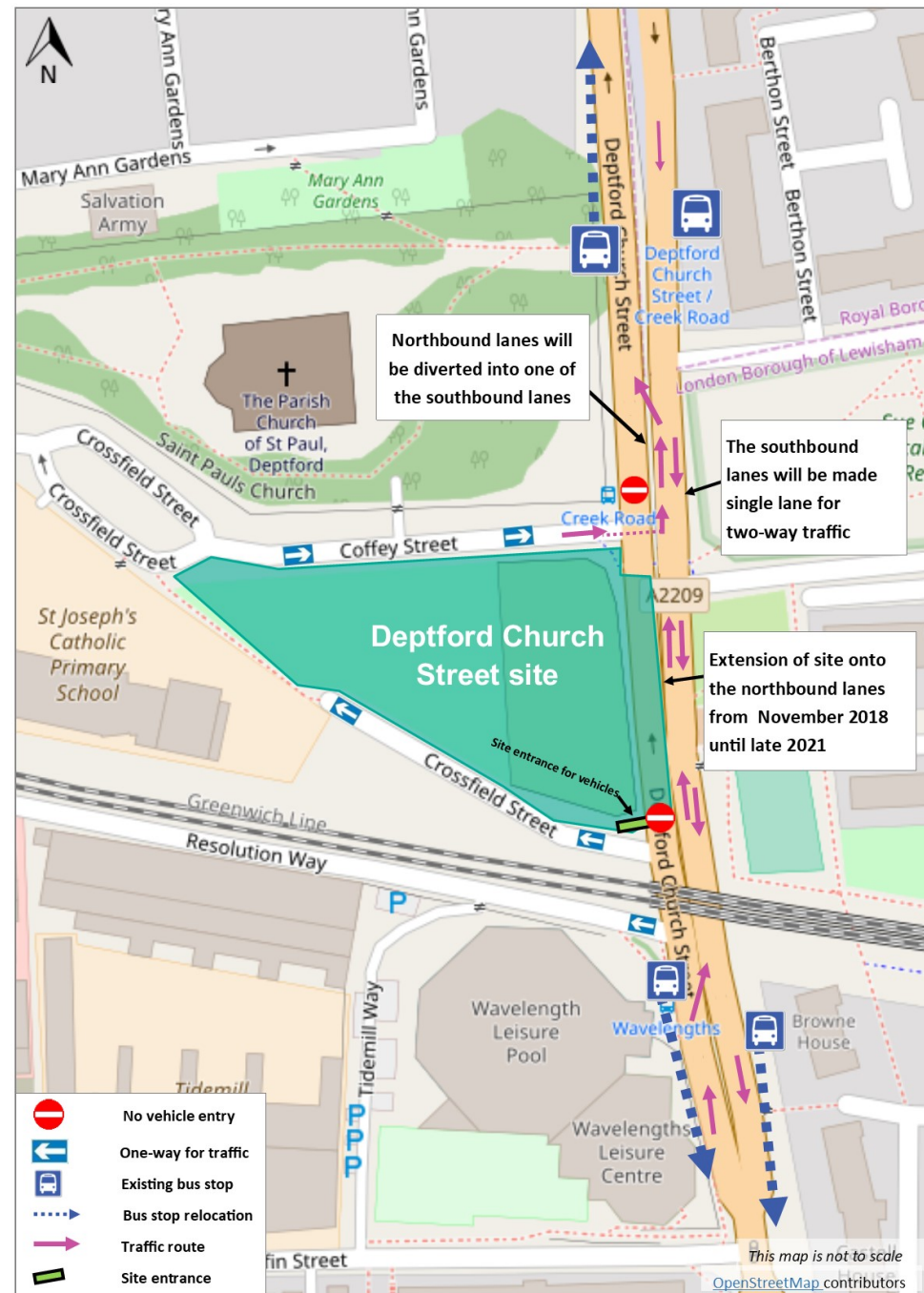



# Noise – DEPCS (May to August 2018)

Noise monitoring locations:

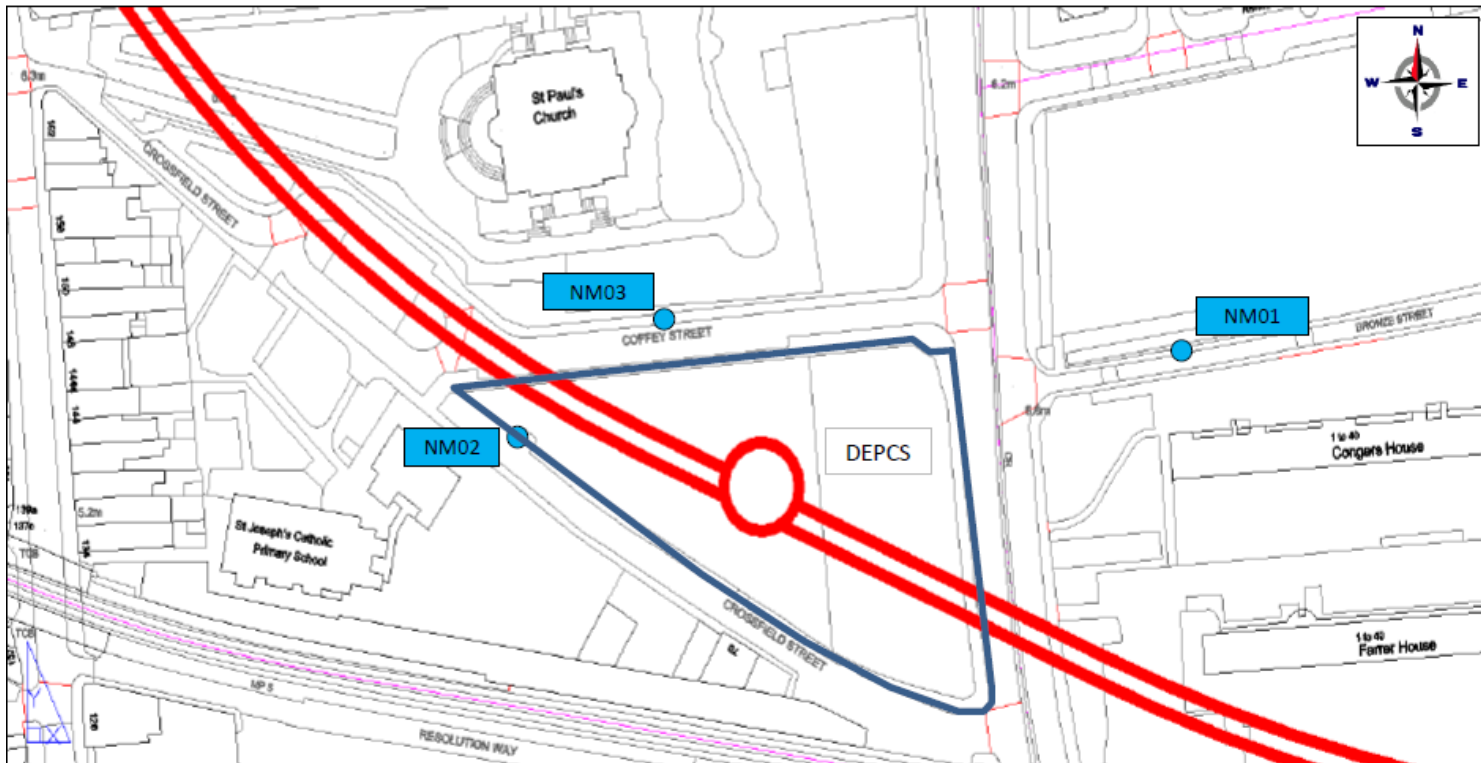

Over the period May to August 2018:

- ❖ No Section 61 exceedances due to CVB works
- ❖ Three TAPs triggers due to CVB works at residential receptor monitor NM01 only
  - 26/06/18 due to CSO/dwall works in extended hours
  - 25/07/18 due to concrete pour in extended hours
  - 06/08/18 due to concrete pour in extended hours
  - This level should not be exceeded more than 10 times in 15 consecutive days or 40 times in any 6 month period. At DEPCS there have been 3 TAPs triggers in the last 6 months and the max number of triggers in any 6 month period since start is 3.

# Air quality – DEPCS (May to August 2018)

Air Quality monitoring locations for particulate monitoring (PM10) (AA)  
Passive N<sub>2</sub> monitoring using diffusion tubes (DT)

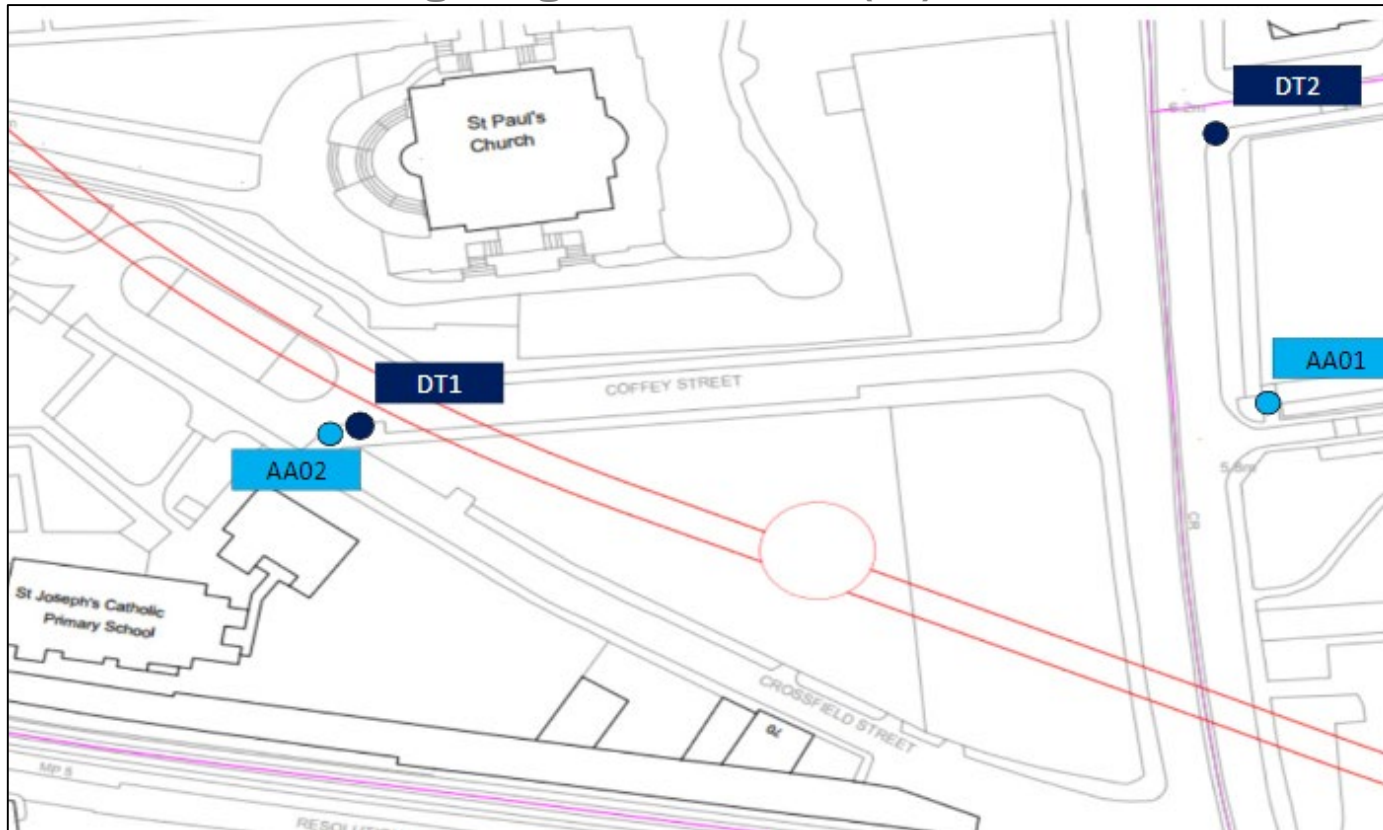

- ❖ 'Moderate' air pollution episode 5th-8th May 2018 was reported by London Air Quality Network (LAQN) during May however no other moderate and high particulate episodes were reported for June, July and August.
- ❖ Over the period May to August 2018 no exceedances were reported for the 24hour PM<sub>10</sub> Alert.
- ❖ Over the period 28/03/2018 to 01/08/18 2018 diffusion tube results were below the UK long-term Air Quality Objective annual average for NO<sub>2</sub> µg/m<sup>3</sup>

# Greenwich Pumping Station





# Birds' eye views

July 2018





# Deptford Creek works



# Greenwich - Works Update

## Shaft

- Finished the diaphragm walls of the shaft and sewage interception chamber
- Removed 70% of the shaft guide wall, before forming its capping beam

## Acoustic enclosure

- Finished installing the acoustic enclosure foundations

## Marine

- We have installed 70% of the sheet piles to form the marine berth retaining wall within Deptford Creek
- Mooring piles in the Creek also approximately 70% complete



# Night works to install the acoustic enclosure

- To contain construction activities within and around the shaft, reducing noise and dust from site
- Will involve installing the steel structure followed by cladding and roof
- Due to the proximity of the DLR viaduct, some construction activities need to take place when the DLR is not operational, at night
- A majority of work will still take place during day time working hours, with limited essential night works permitted between the hours of 22:00 and 07:00, Monday to Sunday
- We plan to finish all night works within 9 weeks

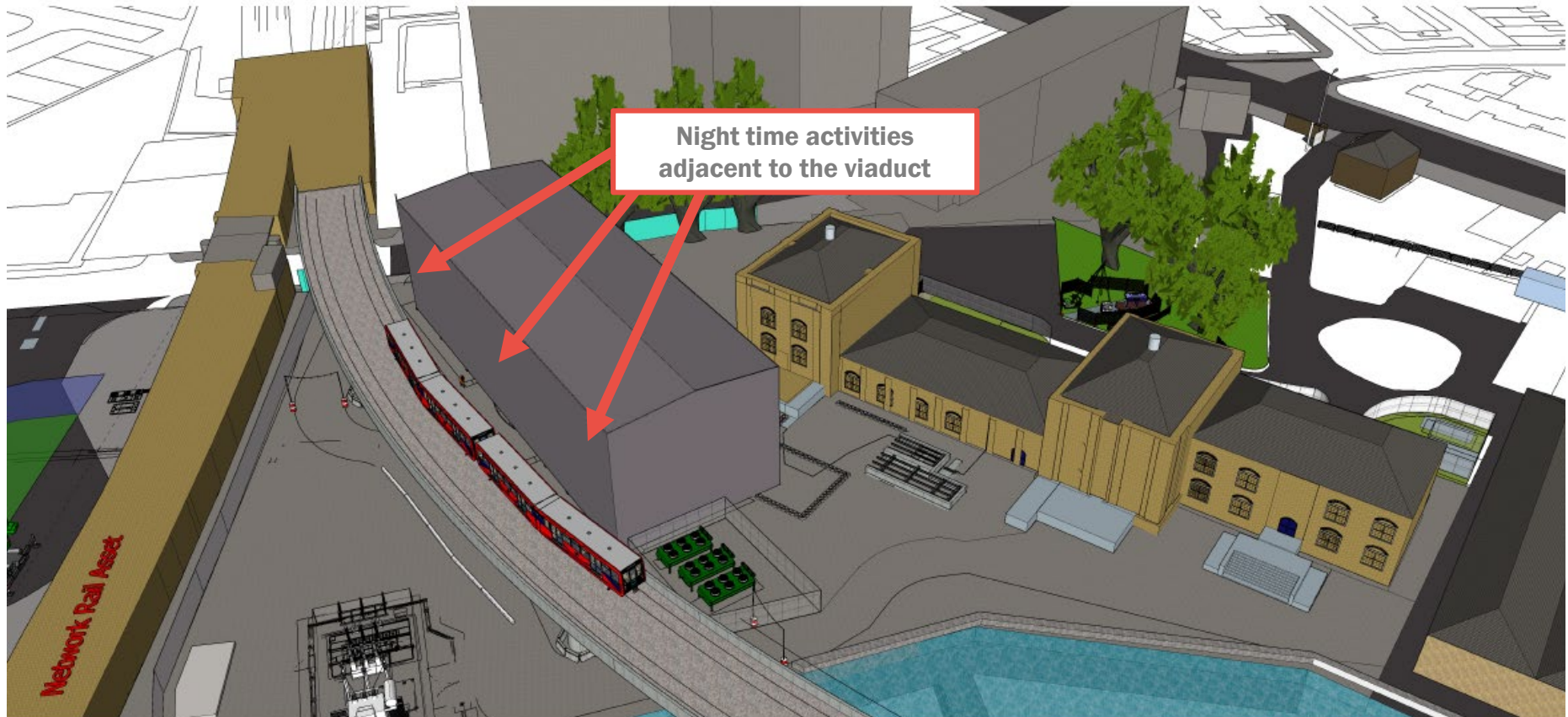



# Construction of Chambers Wharf Acoustic Enclosure



September



# Construction of Chambers Wharf Acoustic Enclosure

September 2018





# Kirtling Street Acoustic Enclosure



# Greenwich - The next 6 months

Programme Overview	2018			2019		
	Oct	Nov	Dec	Jan	Feb	March
Shaft & CSO capping beam						
Acoustic Enclosure construction (steelwork and cladding)						
Cooling Pond Removal						
Shaft Excavation						
Martello Pilling						
More by River marine works						
Phoenix Wharf CFA Pilling						
Phoenix Wharf Muckbin Excavation						

Working Hours	Standard	Extended	Night	Continuous
Mon-Fri	08:00-18:00	18:00-22:00	22:00-07:00	00:00-00:00
Saturday	08:00-13:00	13:00-17:00	22:00-07:00	00:00-00:00
Sunday	-	-	22:00-07:00	00:00-00:00

1 hour allowed before & after for mobilisation/demobilisation

# Noise – GREPS (May to August 2018)

## Noise monitoring locations

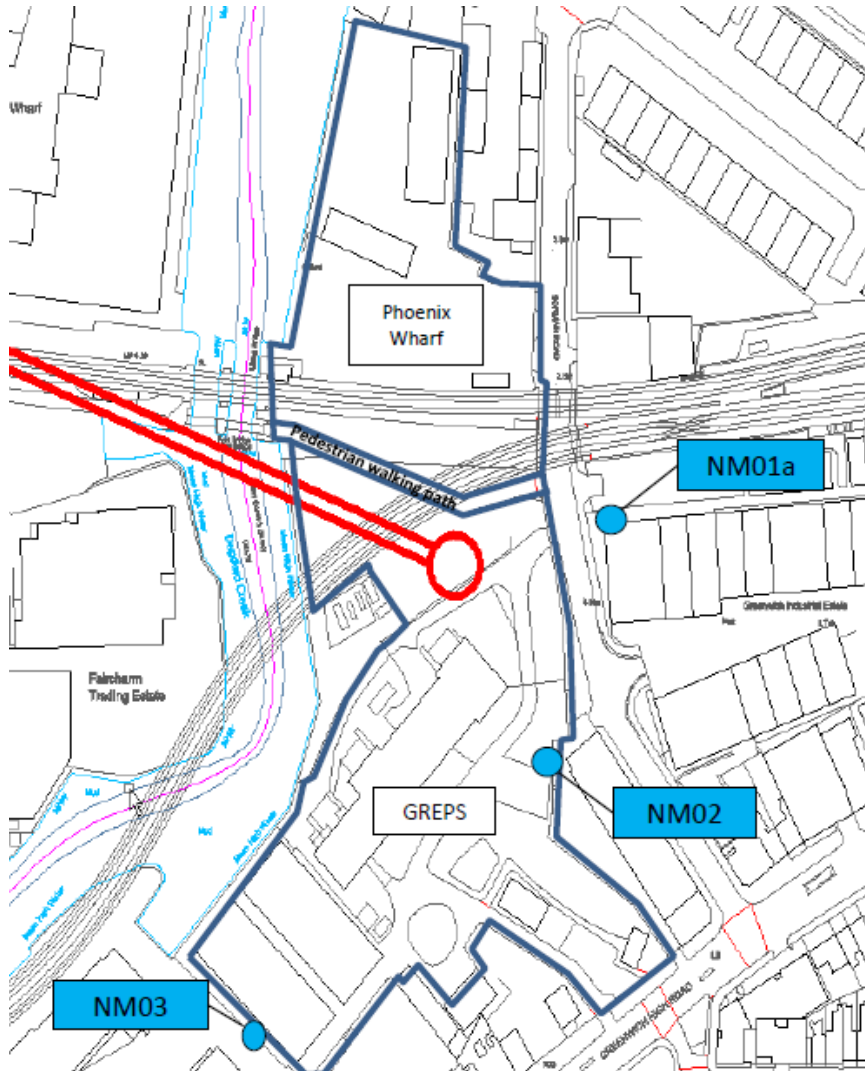

Over the period May to August 2018:

- ❖ No Section 61 exceedances due to CVB works
- ❖ Two TAPs triggers due to CVB works at residential receptor monitor NM01a
  - 30/05/18 due to d-wall works in extended hours
  - 13/06/18 due to concrete cutting works in standard hours
  - This level should not be exceeded more than 10 times in 15 consecutive days or 40 times in any 6 month period. At GREPS NM01a there have been 8 TAPs triggers in the last 6 months and the max number of triggers in any 6 month period since start is 13.
- ❖ No TAPs triggers due to CVB works at residential receptor monitor NM03 and no triggers in any 6 month period since start





# Air quality – GREPS (May to August 2018)

## Air Quality monitoring locations for particulate monitoring (PM<sub>10</sub>)

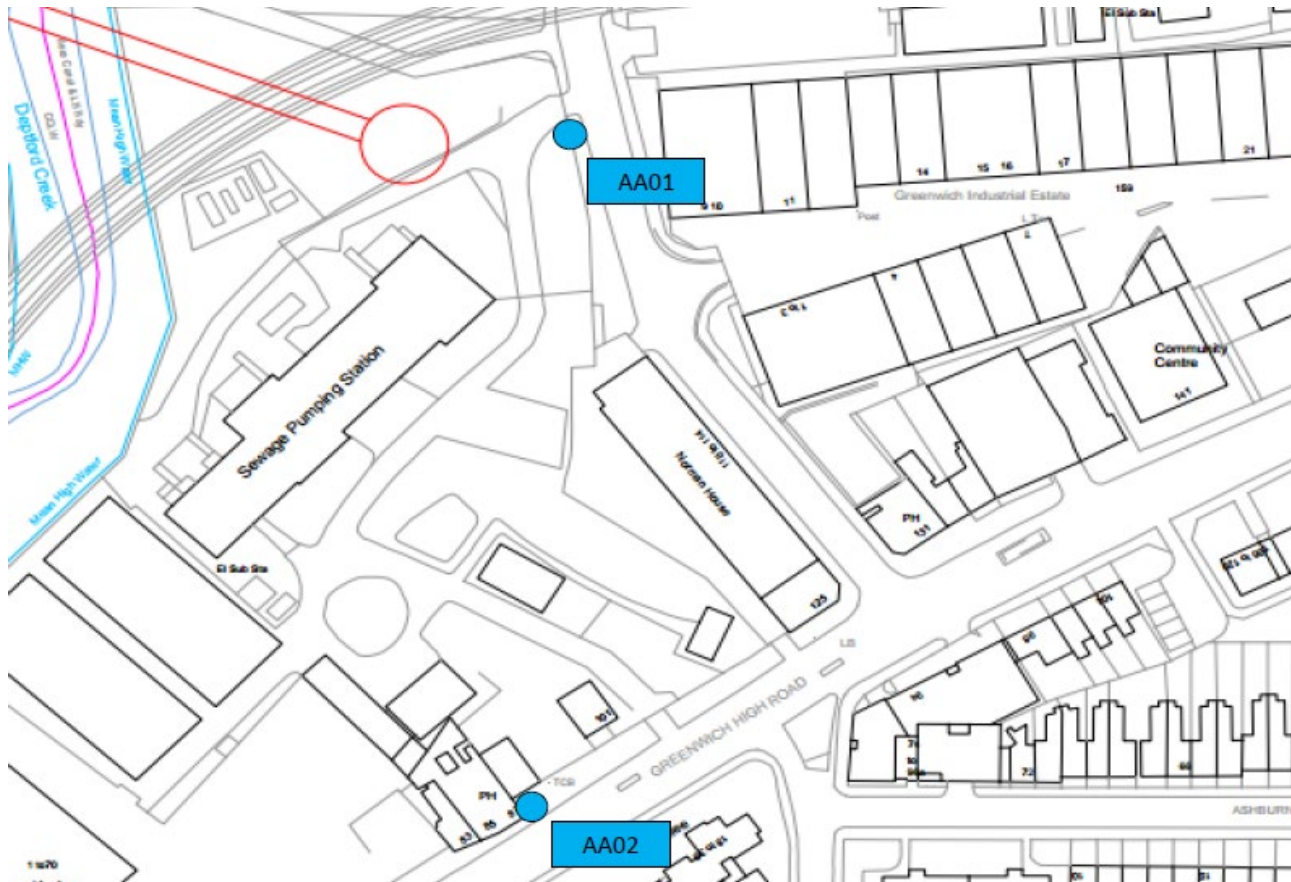

- ❖ ‘Moderate’ air pollution episode 5th-8th May 2018 was reported by London Air Quality Network (LAQN) during May however no other moderate and high particulate episodes were reported for June, July and August.
- ❖ Over the period May to August 2018 no exceedances were reported for the 24hour PM<sub>10</sub> Alert.

# **Community Relations across Tideway East**

# Hoarding artwork



I hope, overall, that nobody  
 being young the world  
 The world, using digital  
 The world, using digital  
 digital, how and that, the world  
 of how, how, how, how, how,  
 I really, as a  
 moment that  
 lives underwater





# Deptford Church Street Hoarding: Feedback

*“I think it unites. It gives a feeling of togetherness.”*

*“It's great, it's bright – a real improvement to what was there before. Bright, diverse, engaging. I like that it's real – and that it shows children.”*

*“It makes me think of how Deptford has changed over time.”*

*“ “I love it being so public. Makes this place so beautiful. Every day we go past and stop and look at the photographs.”*

*“This work brightens up place a lot. It is sending out an important message: be who you are, do what you enjoy. We need more things like this here. Positive things showing our children that they can achieve a lot in their lives. It is good, calming. Sea-like.”*

*“This is a positive celebration of individuality.”*

*“Stunning pictures. Great display. This used to be my school.”*

**RIVER TIMES –  
Summer  
Edition  
delivered**



A digital copy of this publication can be found at  
[https://www.tideway.london/media/4081/river-times\\_east\\_summer\\_18.pdf](https://www.tideway.london/media/4081/river-times_east_summer_18.pdf)



# Next Generation of Engineering

## Apprenticeships

- Three new civil engineering apprentices have joined our team
- Two are studying degree level 6 qualifications

## Work experience

Four Summer work experience students.

Two from the St Michael's College, one from Walworth Academy and one from East Young Leaders Academy (EYLA). Some feedback:

*“Thanks to my work experience I have been able to develop a wide range of skills, including working as part of a team, listening and organisation. It's also helped boost my confidence.”*

*“Getting a feel for Engineering at Tideway has really encouraged me to go on and work in Engineering.”*

*“Engineering is now definitely an option for my future.”*



**World of Work visit from students taking part in the National Citizen Service summer programme 'The Challenge'**

**They practised their Dragon's Den style presentation with Tideway staff**

# Foreshore clean-ups on the Isle of Dogs & King Edward Memorial Park foreshore

Staff volunteers, accompanied by the Ecology Consultancy, took to the Isle of Dogs foreshore this Summer to remove plastic waste embedded within its 'beach'.

Among the fifty bags of plastic rubbish collected they found a bag of Smiths salted peanuts with an expiry date of January 1984.



Newcastle Draw Dock - August 2018

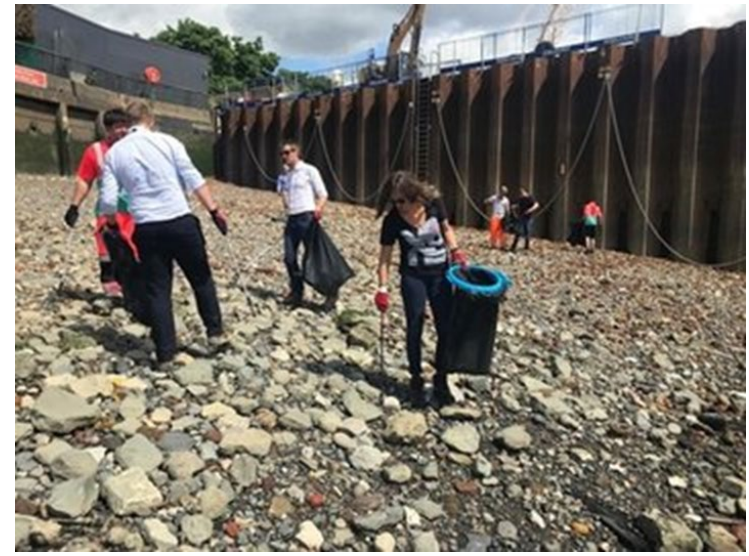

King Edward Memorial Park Foreshore- July 2018

In July Tideway East volunteers were on the foreshore near to King Edward Memorial Park cleaning up plastic rubbish.

The team was able to collect many bags full of plastic, to keep it out of the river and the aquatic food chain.



# “Plogging”- Picking up litter & Jogging

Earl Pumping Station site staff volunteers took part in a litter collection whilst they jogged around Rotherhithe.

Two black bags of rubbish were collected during their lunchtime run.



Earl Pumping Station  
August 2018

# Big Ben Challenge – 20km Paddle Board



**As part of the Tideway Foreshore Festival in September, a team of paddle boarders from Earl Pumping Station paddled from Putney Bridge in aid of 4 local charities.**

# Charity fund raising

- In July, five members of staff from Tideway East completed the British 10K run
- The team ran in support of the Deborah Ubee Trust, a mental health charity based in Greenwich, raising over £800
- In September staff raised over £550.00 by holding a Macmillan Coffee Morning
- Many of the bakes were hand made by staff and their families.
- A staff member is also running a half marathon to raise money for Macmillan on 14 October.





# Staff Charity 2018 Tideway East

Great Ormond Street Hospital was chosen by staff in June to be this year's chosen charity

## Great Ormond Street Hospital

The money was raised through a variety of staff activities including a raffle and a World Cup Sweepstake

Since April, Tideway East has raised over **£2,000**



**Great  
Ormond  
Street  
Hospital  
Charity**

# Tideway 2017/18 Annual Report

Significant progress has been made on the project over the last 12 months with much of it is captured in Tideway's 2017/18 Annual Report.

In the year to 31 March 2018, we hit some key milestones, with all but one of our 21 construction sites up and running, the completion of the first shafts and the arrival of three of our six Tunnel Boring Machines.

The report highlights Tideway's commitment to use the river and cut the number of lorries needed for the project – with nearly 420,000 tonnes of material moved by barge to date, avoiding more than 20,000 lorry loads on London roads.

*Report can be found at:*

[https://www.tideway.london/media/4029/tideway-annual\\_report\\_2017-18.pdf](https://www.tideway.london/media/4029/tideway-annual_report_2017-18.pdf)

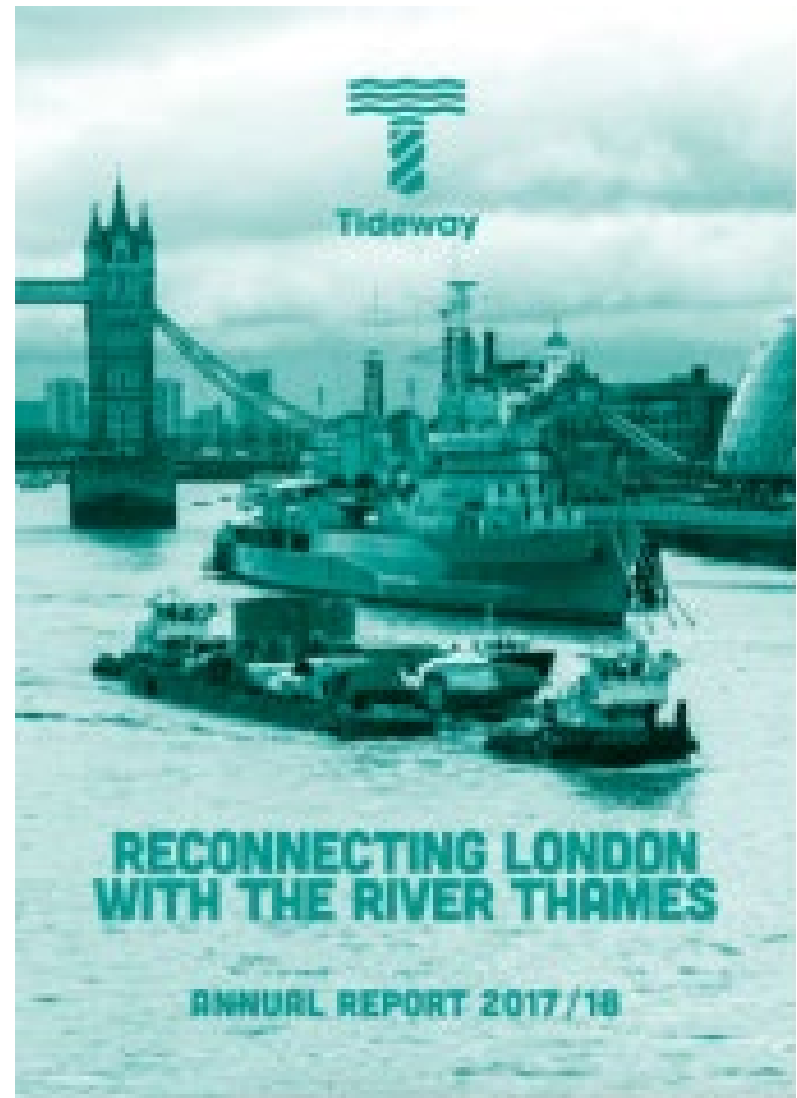

**If you have any questions or enquiries please contact the Tideway Helpdesk on:**

**Telephone: 08000 308080**

**Email: [Helpdesk@Tideway.London](mailto:Helpdesk@Tideway.London)**