

For continuation see drawing sheet 1

Mapping reproduced by permission of Ordnance Survey on behalf of HMSO. © Crown Copyright and Database right 2015. All rights reserved. Ordnance Survey licence number 100056637



Coordinates are to be Ordnance Survey Datum OSGB36. All levels are in metres and relate to the Tunnel Datum which is 100 metres below Ordnance Datum Newlyn.

- Key:**
- Limits of land to be acquired or used (LLAU)
  - - - Zone within which permanent above ground structures would be located
  - - - Authorised channel
  - \* Listed buildings/structures
  - ⊙ Existing trees within surveyed area (trunk sizes vary)
  - ⊕ Proposed trees

- Rev 1:**
1. Temporary and permanent vessel mooring access ramp revised. Anchors and chains shown. Service mooring reinstated on piles. LLAU extended.
- Rev 2:**
1. Service mooring removed.
  2. One purple parameter removed.
  3. New mooring location revised.

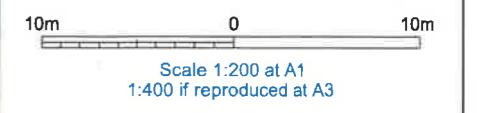

**FOR APPROVAL**

**Location**  
**Victoria Embankment Foreshore**  
 City of Westminster

**Document Information**  
**Application for Development Consent**  
 Proposed  
 Landscape plan sheet 2 of 2  
 Book of plans - section 18  
 DCO-PP-16X-VCTEF-180013 - Rev 2  
 Sept 2022

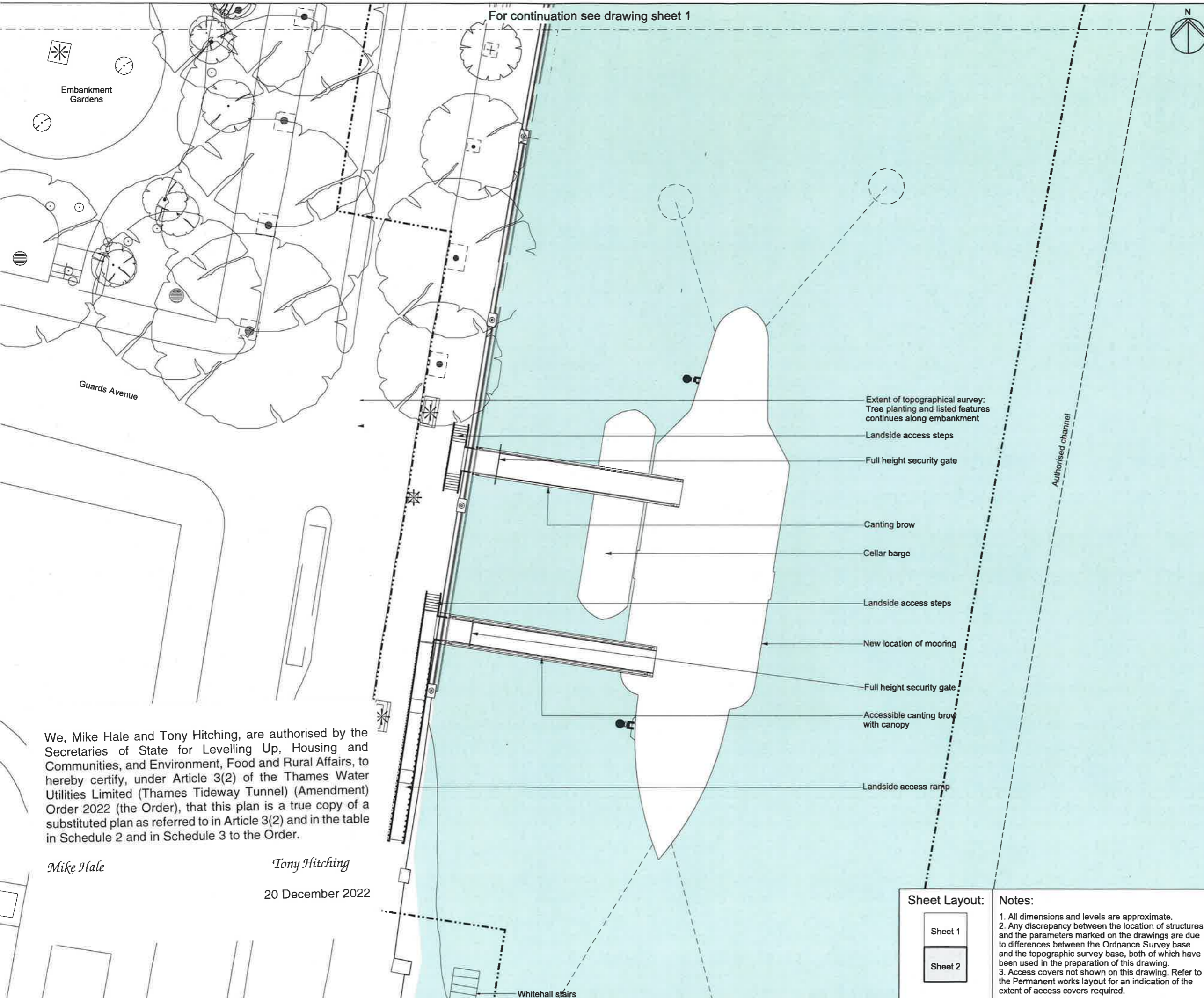

- Extent of topographical survey: Tree planting and listed features continues along embankment
- Landside access steps
- Full height security gate
- Canting brow
- Cellar barge
- Landside access steps
- New location of mooring
- Full height security gate
- Accessible canting brow with canopy
- Landside access ramp

We, Mike Hale and Tony Hitching, are authorised by the Secretaries of State for Levelling Up, Housing and Communities, and Environment, Food and Rural Affairs, to hereby certify, under Article 3(2) of the Thames Water Utilities Limited (Thames Tideway Tunnel) (Amendment) Order 2022 (the Order), that this plan is a true copy of a substituted plan as referred to in Article 3(2) and in the table in Schedule 2 and in Schedule 3 to the Order.

*Mike Hale* *Tony Hitching*  
 20 December 2022

**Sheet Layout:**

Sheet 1
Sheet 2

**Notes:**

1. All dimensions and levels are approximate.
2. Any discrepancy between the location of structures and the parameters marked on the drawings are due to differences between the Ordnance Survey base and the topographic survey base, both of which have been used in the preparation of this drawing.
3. Access covers not shown on this drawing. Refer to the Permanent works layout for an indication of the extent of access covers required.