

Mapping reproduced by permission of Ordnance Survey on behalf of HMSO. © Crown Copyright and Database right 2015. All rights reserved. Ordnance Survey licence number 100056637



Coordinates are to be Ordnance Survey Datum OSGB36. All levels are in metres and relate to the Tunnel Datum which is 100 metres below Ordnance Datum Newlyn.

Key:
 Maximum temporary extent of loss of listed buildings / structures

Notes:
 1. All dimensions and levels are approximate.
 2. Drawing to be read in conjunction with conservation statement.

Rev 1:
 1. Maximum permanent extent of loss for new mooring brows added.

Rev 2:
 1. Maximum permanent extent of loss for new mooring brows removed.
 2. Location of vessel revised.

Sheet Layout:

Scale 1:200 at A1
 1:400 if reproduced at A3

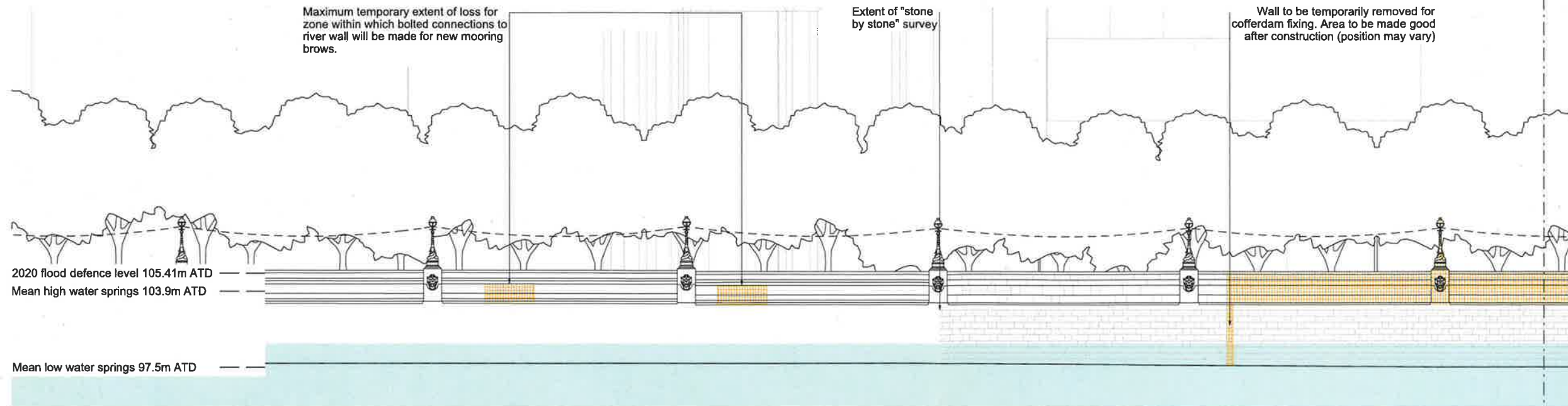

Existing river elevation

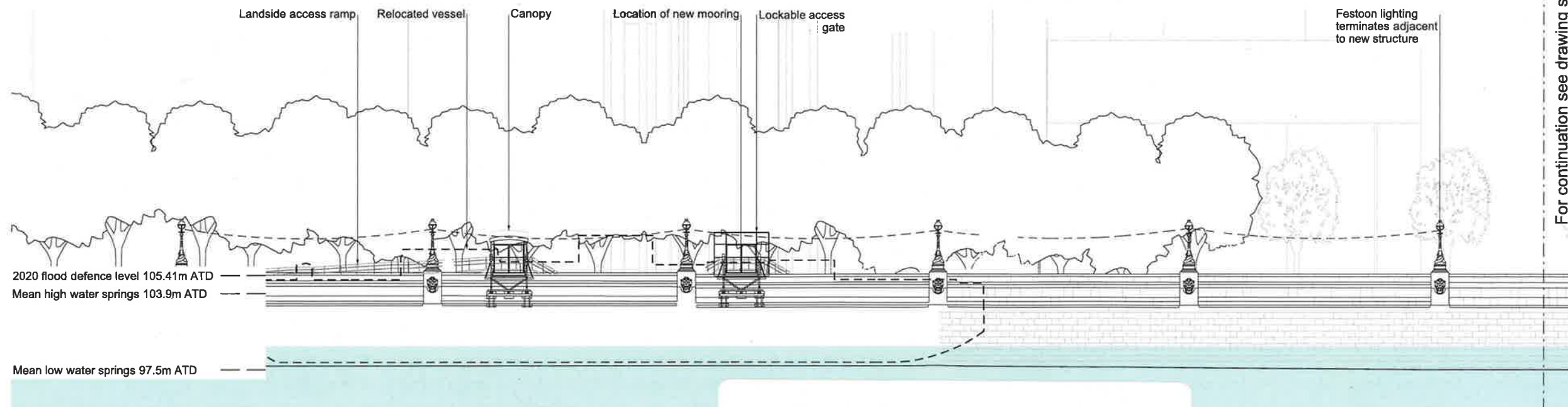

Proposed river elevation

We, Mike Hale and Tony Hitching, are authorised by the Secretaries of State for Levelling Up, Housing and Communities, and Environment, Food and Rural Affairs, to hereby certify, under Article 3(2) of the Thames Water Utilities Limited (Thames Tideway Tunnel) (Amendment) Order 2022 (the Order), that this plan is a true copy of a substituted plan as referred to in Article 3(2) and in the table in Schedule 2 and in Schedule 3 to the Order.

Mike Hale

Tony Hitching

20 December 2022

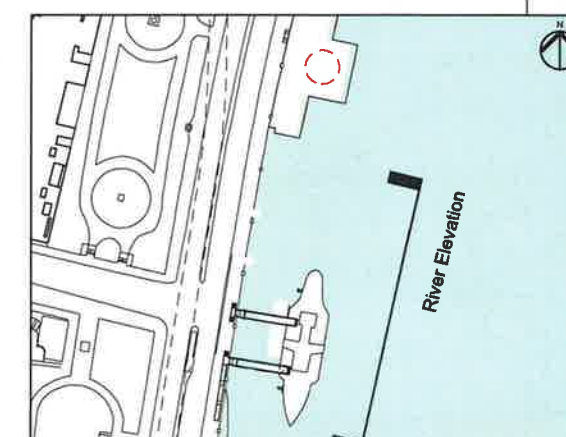

Location
Victoria Embankment Foreshore
 City of Westminster

Document Information
Application for Development Consent
 As existing and proposed river elevation
 Impact on listed structure (sheet 1 of 2)
 Book of plans - section 18
 DCO-PP-16X-VCTEF-180047 - Rev 2
 Sept 2022

